



**DELPHIA**  
*Mindful Cruising*

# MARTIN SCHEMKES

Brand Director



Delphia boats promise a new way of cruising in inland waters and at sea: calm, aware, respectful of the environment and of others. Agreeing to slow down means giving yourself the opportunity to gain in serenity, to live more intensely the moments spent on the water. It is a desire that we sense in some people, and one that goes hand in hand with greater ecological awareness.

The introduction of new, more sustainable materials, the constant concern to control the environmental impact of boating, minimised energy consumption thanks to an optimised hull shape and reduced cruising speed are our first responses to the new expectations of these customers”



We believe that deceleration is the key to enjoyable and relaxing cruising at sea. That is why we give owners and passengers the opportunity to enjoy moments of pleasure on boats designed for comfort, convenience and ease of use. Our teams are constantly looking for innovations and more durable materials to give you the best possible cruising experience.

Inspired by nature, Delphia aims to offer its customers an unprecedented level of relaxation on board, characterised by the use of intelligent solutions and sustainable materials. At Delphia, we call this 'Mindful Cruising'.

# MINDFUL CRUISING

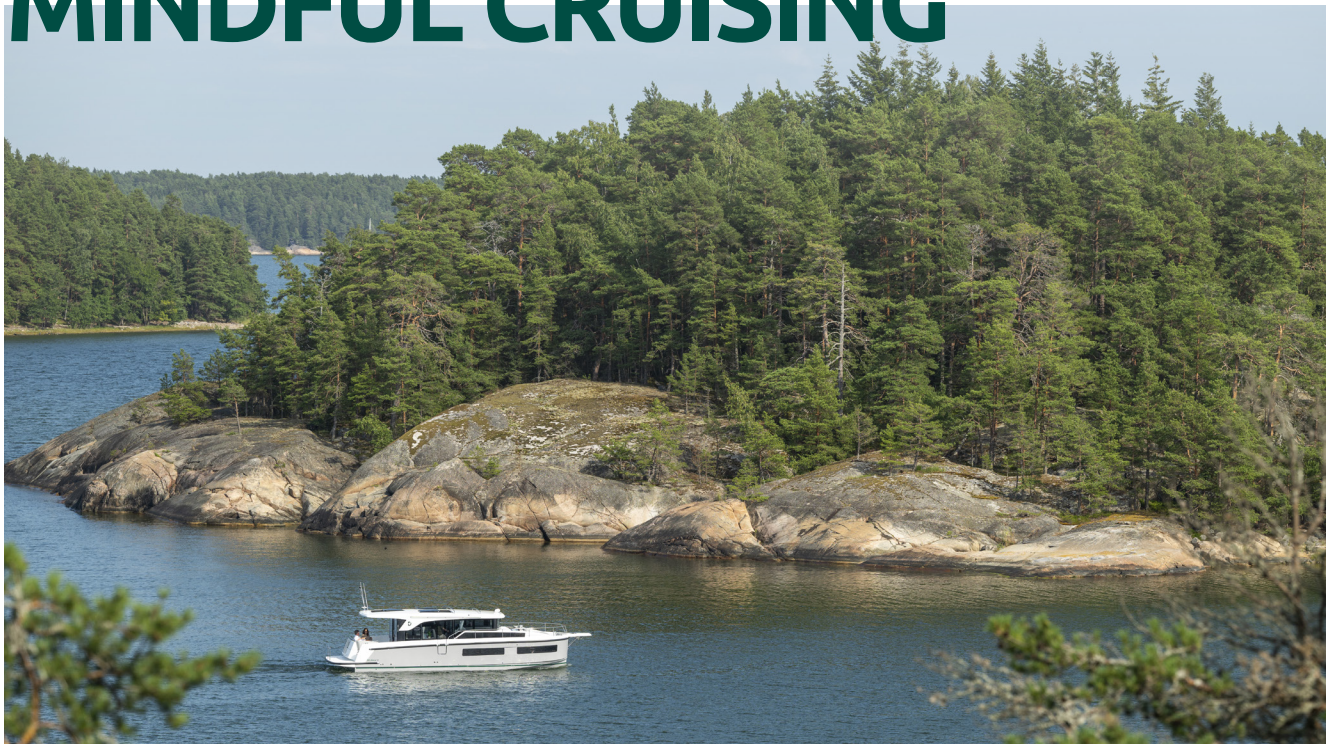



# MINDFULNESS

Rekindle the sacred bond with your essence and those dear, allowing the dance of genuine moments to unfold in the tranquil embrace of serenity. Amidst the ethereal sanctuary of Delphia, discover the art of leisurely cruising: a blissful communion with nature, where every ripple echoes the harmonious melody of a home found in the heart, away from the mundane.

A vertical photograph of a woman with long blonde hair, wearing a light blue sweater and dark pants, sitting cross-legged on a sandy beach. She is looking out at the ocean under a clear blue sky. In the background, there are waves breaking on the shore and a distant landmass. The foreground shows some dry grass and sand.

# ADVANCED SIMPLICITY

We believe in advance simplicity and peaceful cruising. Embark on a voyage though to make your life onboard easier. From safety to ergonomics, our boats are crafted to live an experience in complete serenity.

# COLLECTION



**Our boats are designed for you, to  
slow down in style and comfort. Open  
yourself to the inland waterway  
and cruises at sea in a greener way.  
See our collection of boats >**

\*Information presented in this document may vary, change or not be precise due to change of specification or performance of products supplied by third party, boat's equipment and condition and moreover sea and weather condition. Please contact Stocznia Jachtowa Delphia Sp. z o. o. on our website [www.delphiayachts.com](http://www.delphiayachts.com) for the most current and relevant product information for your application.

## DELPHIA 10 models

Overall length 9.78 m  
Hull length 8.96 m  
Hull width 3.49 m



Delphia 10 Lounge



Delphia 10 LoungeTop



Delphia 10 Sedan

## DELPHIA 11 models

Overall length 10.77 m  
Hull length 9.99 m  
Hull width 3.85 m



Delphia 11 Sedan



Delphia 11 FlyLounge

## DELPHIA 12 models

Overall length 13.40 m  
Hull length 12 m  
Hull width 4.26 m



Delphia 12 Sedan



Delphia 12 FlyLounge



# DELPHIA 10 LOUNGE

## The ultimate urban getaway

The Delphia 10 Lounge is designed to bring you moments of harmony from the heart of the city to the surrounding countryside...

With its displacement hull, it glides silently through canals and inland waters and along sheltered coastal areas. It allows you to get up close and personal with the local wildlife and to enjoy a calm and serene environment.

Designed for sharing special moments with loved ones, the Delphia 10 Lounge can accommodate up to twelve people thanks to generous and clever main deck layout. Its interior spaces reveals a bright owner's cabin as well as a guest cabin or an office

and an outstanding bathroom including a shower room. The perfect layout for relaxing voyage over several days.

To make your stay as comfortable as possible, the boat has plenty of storage space and a large rear platform that can safely accommodate and recharge up to 2 electric bikes.

The Delphia 10 Lounge offers two propulsion systems: combustion or electric (Torqeedo) which is ideal for urban navigation as well as coastal cruising.



# GENERAL CHARACTERISTICS

## DELPHIA 10 LOUNGE

Overall length	9,78 m
Hull length	8,96 m
Hull width	3,49 m
Draft	0,8 m
Light displacement	5 192 kg
Min. engine power	45 hp
Max. engine power	110 hp
Max. engine power in electric version	80 hp (55,10kW)
Fuel tank	285 L
Max. speed (diesel)	16.5 km/h
Max. speed (electric)	16 km/h
Fresh water tank	380 L
Black water tank	170 L
Grey water tank	170 L
Air draught	2,50 m
CE-category	C10, D10
Designer	Vripack

## Main deck

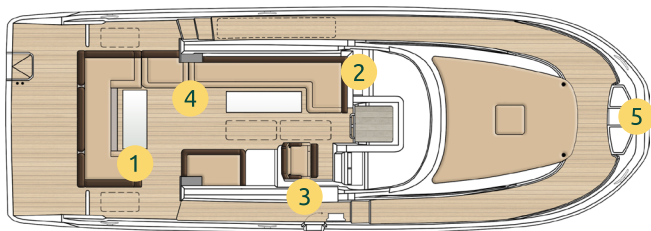

1. Storage for gas bottle
2. Glovebox
3. Hull side gate
4. Removable connection seat
5. Bow sprit with integrated telescopic ladder

## 1 cabin & 1 bathroom

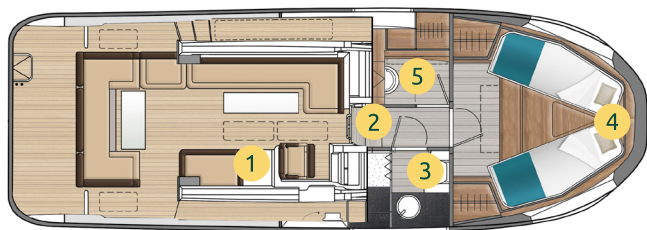

1. Front opening refrigerator
2. Storage under the companionway
3. Bathroom with separate shower
4. Double bed convertible into 2 single beds
5. Office/utility room

## 2 cabins & 1 bathroom

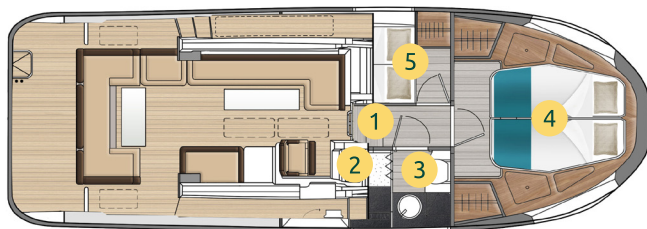

1. Companionway with doors and hatch
2. Helm station
3. Bathroom with separate shower
4. Double bed convertible into 2 single beds
5. Guest cabin with double bed

/ Delphia 10 LOUNGE

« A displacement boat  
in an open deck design offering  
the **best in class cockpit layout** »

**DID  
YOU  
KNOW** ?

The height of the Delphia 10 Lounge is designed to navigate all rivers and canals and will allow you to pass under most of the bridges, even the lowest ones with a maximum height of 2.50 metres.



Convenient  
& socializing



One level living



Electric bike storage and charging







# DELPHIA 10 LOUNGETOP

## Disconnect to reconnect

The Delphia 10 LoungeTop embodies the excellence of cruising in the heart of nature. Ideal for multi-day getaways with family or friends, this model offers the opportunity to explore new horizons in total freedom.

With a spacious cockpit protected by a weatherproof hard top, this boat guarantees safe cruising in all seasons. With 12 seats facing each other, an outdoor galley and two bright double cabins, it is the ideal environment for convivial moments and peaceful nights surrounded by wildlife.

Its electric or diesel engine secure silent and environmentally-friendly cruising. What's more, a system of solar panels can be integrated to power the electrical equipment, making the Delphia 10 LoungeTop the ideal choice for recharging your batteries in the heart of soothing natural landscapes.



# GENERAL CHARACTERISTICS

## DELPHIA 10 LOUNGETOP

Overall length	9,78 m
Hull length	8,96 m
Hull width	3,49 m
Draft	0,8 m
Light displacement	6 270 kg
Min. engine power	45 hp
Max. engine power	110 hp
Max. engine power in electric version	80 hp (55,10kW)
Fuel tank	285 L
Max. speed (diesel)	16.5 km/h
Max. speed (electric)	16 km/h
Fresh water tank	380 L
Black water tank	170 L
Grey water tank	170 L
Air draught	2,55 m
CE-category	C10, D10
Designer	Vripack

# Main deck

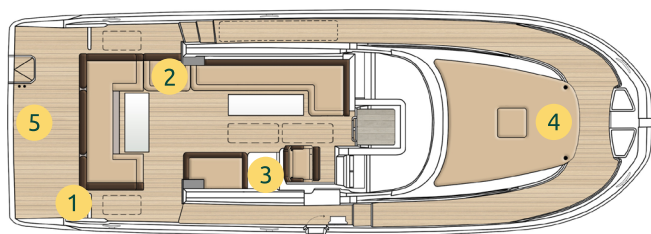

1. Transom gate
2. Removable connection seat
3. Outdoor galley
4. Bow lounge area
5. Bathing platform

## 1 cabin & 1 bathroom

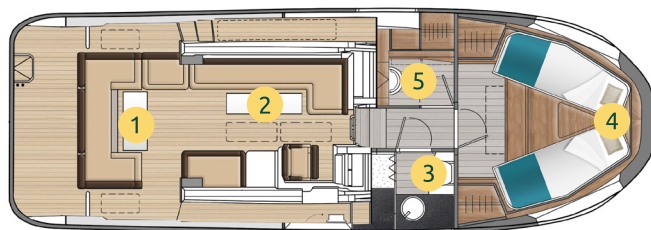

1. Cockpit table
2. Dining table
3. Bathroom with separate shower
4. Double bed convertible into 2 single beds
5. Office/laundry room

## 2 cabins & 1 bathroom

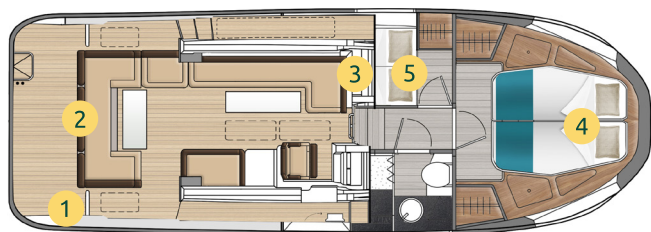

1. Transom gate
2. Sliding cockpit bench backrest
3. Folding forward looking bench
4. Double bed convertible into 2 single beds
5. Guest cabin with double bed

/ Delphia 10 LOUNGETOP

« Unique balance between  
comfort and safety »

DID  
YOU  
KNOW ?

You can cover more than 1.600 km  
on a full diesel tank or more than  
228 km with full battery capacity  
(76kWh) at cruising speed of 8 km/h.

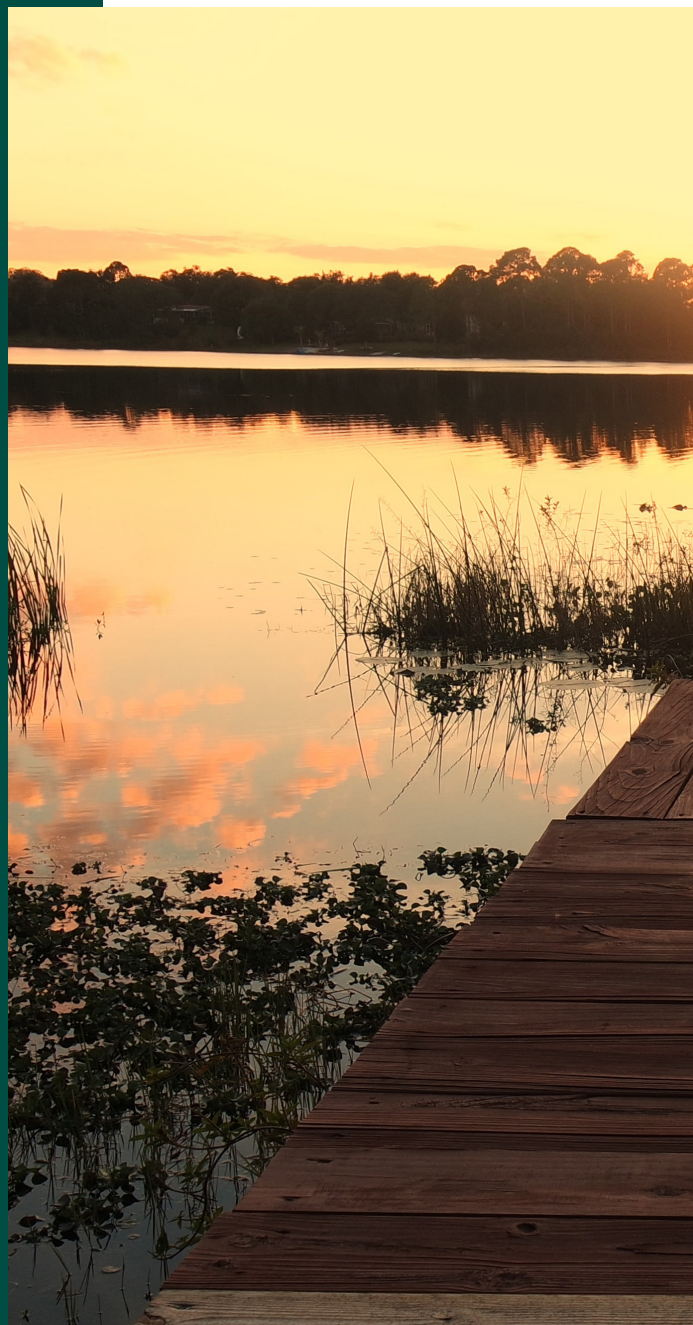

Always together



50% open 50% closed



Contemporary design





# DELPHIA 10 SEDAN

## The boat for all your family cruises

The Delphia 10 Sedan is an invitation for a retreat on the water. This boat promises great family outings during long stays on the water, with an exceptional quality of life on board and preserved privacy.

Behind the spacious helm station offering a 360° panoramic view, the captain can operate the boat single-handed. With an ergonomic positioned steering wheel, an engine throttle and thruster controls combined with a sliding side door and a hull exit door, the navigation and docking become simple and safe.

Inside, the 2 cabins and bathroom are offering an ample space and are bathed in natural light thanks to the large hull portlights positioned close to the

water level. An additional version is available with one cabin and an office, offering workspace for children and parents.

Design choices such as warm materials, a large salon, a well-equipped galley and plenty of storage space create a cosy and welcoming atmosphere.

Powered by a diesel or an electric engine, the Delphia 10 Sedan invites you to enjoy a peaceful and stress-free cruising with an ability to pass under most of the bridges with ease or to cruise along the coasts.

The boat is equipped with a bike rack, allowing you to easily explore the coast while your boat recharges.



# GENERAL CHARACTERISTICS

DELPHIA 10 SEDAN	
Overall length	9,78 m
Hull length	8,96 m
Hull width	3,49 m
Draft	0,8 m
Light displacement	6 270 kg
Min. engine power	45 hp
Max. engine power	110 hp
Max. engine power in electric version	80 hp (55,10kW)
Fuel tank	285 L
Max. speed (diesel)	16.5 km/h
Max. speed (electric)	16 km/h
Fresh water tank	380 L
Black water tank	170 L
Grey water tank	170 L
Air draught	2,55 m
CE-category	C10, D10
Designer	Vripack

# Main deck

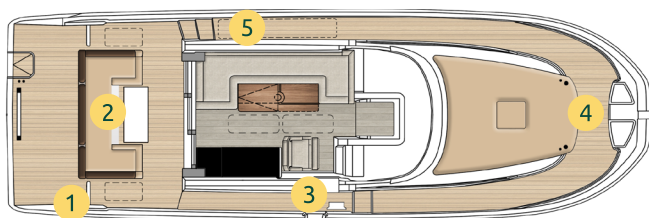

1. Transom gate
2. U-shaped cockpit bench
3. Sliding side door at helm
4. Symetrical side decks
5. Storage for fenders and mooring lines

## 1 cabin & 1 bathroom

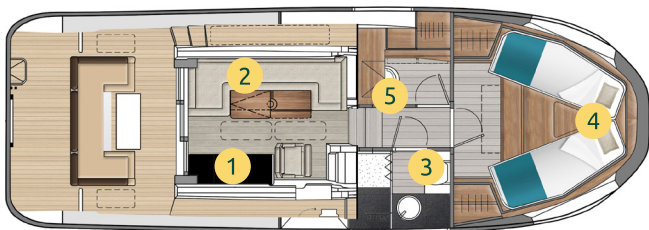

1. Full functional galley
2. Dining table
3. Bathroom with separate shower
4. Double bed convertible into 2 single beds
5. Office/ utility room

## 2 cabins & 1 bathroom

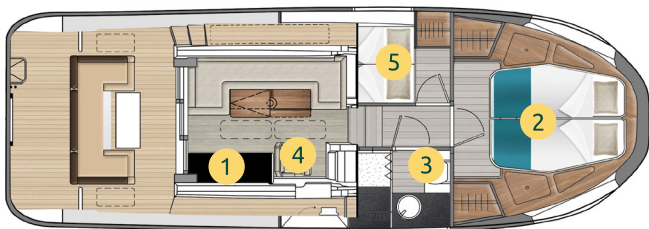

1. Full functional galley
2. Double bed convertible into 2 single beds
3. Bathroom with separate shower
4. Helm station
5. Guest cabin with double beds

/ Delphia 10 SEDAN

« Ideal boat for long journeys  
throughout Europe or just  
long weekends with family and  
friends »

DID  
YOU  
KNOW ?

Natural light has many benefits for our health, such as increasing vitamin D, helping to improve our metabolism, and improving sleep.

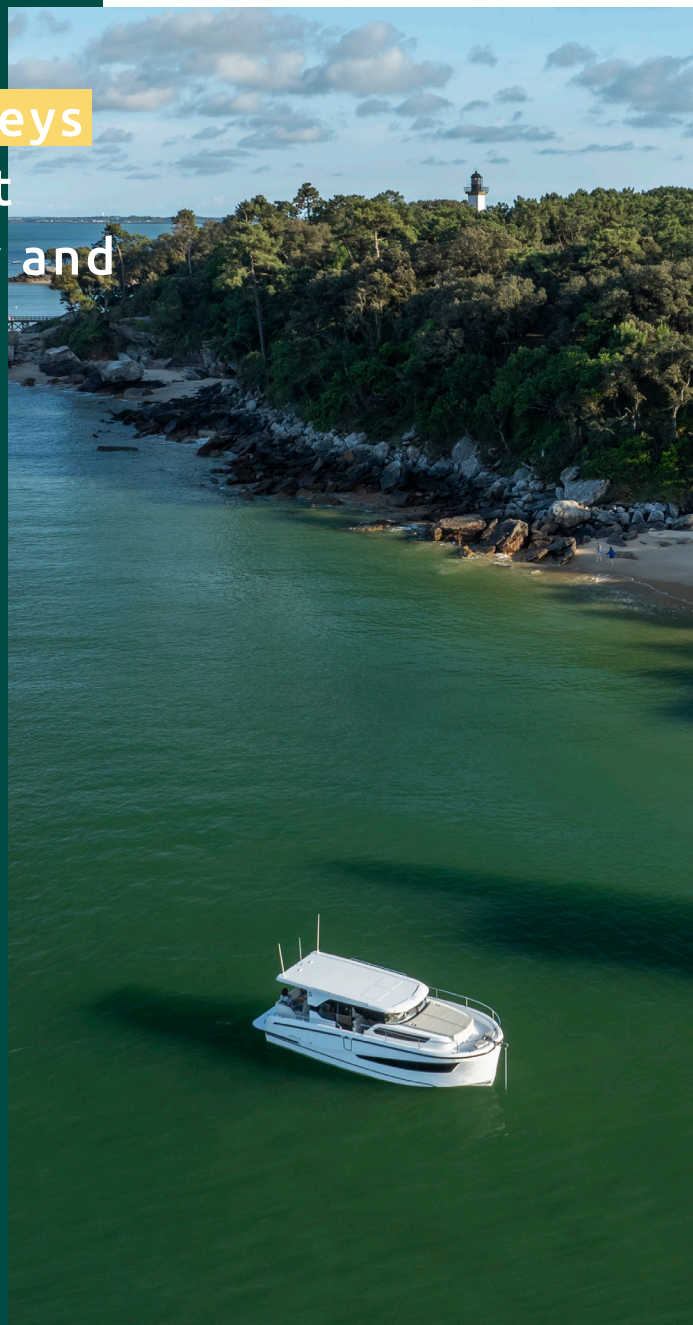



Comfort zone, a feeling of being at home



Panoramic views



Seagoing





# ELECTRIC CONCEPT

Performances: DELPHIA 10 models



**“Can you imagine cruising in complete silence?  
Can you imagine breathing clean air?  
Can you imagine being part of a better future?**

**”**

With their three performance systems, our electric motors offer the possibility to navigate more eco-responsibly and consciously. At Delphia, we call it Mindful Cruising.

\*All data are based on sea trials in MLC condition, flat seas, no wind, sea and outside temperature below 10° celsius and may vary due to water density and type of propeller

“Life” represents a first step in Delphia’s conscious boating for boaters who use their boats in limited boating areas, such as lakes, urban areas or who tend to enjoy short cruises or day trips.

## LIFE



Electric motor **55,10 kW (80 HP)**



Battery capacity **38 kWh**



Charger **3.2 kW (1 x 16 A)**

## RANGE

SPEED	TIME	DISTANCE
6 km/h (3.2 kts)	18h00	114 km (61 nm)
8 km/h (4.3 kts)	9h30	76 km (41 nm)
10 km/h (5.5 kts)	5h45	57 km (31 nm)
12 km/h (6.5 kts)	2h30	31 km (17 nm)

## CHARGING TIME [3.2 kW]

Destination charge  
(40 - 80%)

5 H

Realistic charge  
(20 - 100%)

10.5 H

Full charge  
(0 - 100%)

12 H

- 1 Powerful 80hp Deep Blue electric motor
- 2 360V high capacity lithium battery system, totalling 80kWh (76kWh usable)
- 3 Shore power chargers
- 4 System management unit
- 5 Electronic throttle
- 6 Display with onboard computer
- 7 6kW DC/AC converter

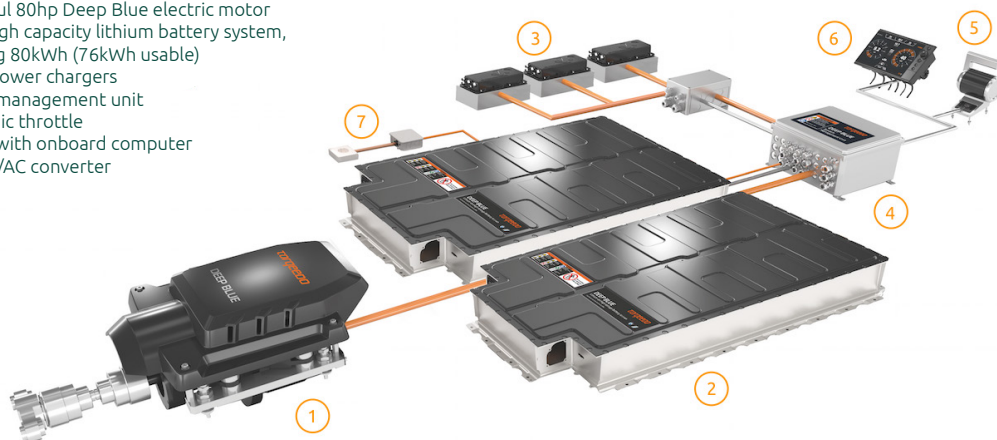



Electric motor **55,10 kW (80 HP)**



Battery capacity **76 kWh**



Charger **3 x 3.2 kW (1 x 16 A / 3 x 16A)**

## RANGE

SPEED	TIME	DISTANCE
6 km/h (3.2 kts)	12h00	228 km (122 nm)
8 km/h (4.3 kts)	19h00	152 km (82 nm)
10 km/h (5.5 kts)	11h30	115 km (62 nm)
12 km/h (6.5 kts)	5h00	62 km (34 nm)

## CHARGING TIME

Destination charge  
(40 - 80%)

9<sup>H50</sup>

3<sup>H20</sup>

Realistic charge  
(20 - 100%)

19H

6<sup>H30</sup>

Full charge  
(0 - 100%)

24H

8H

[3.2 kW]  
[9.6 kW]

# CRUISE

The «Cruise» system is designed for explorers who like to take their loved ones to isolated bays or remote villages, and who are looking for greater autonomy and additional features.





“Rapid” system, it is a look into the future - meaning that, those owners who navigate in areas where infrastructure is already in place for fast charging.

## RAPID



Electric motor **55,10 kW (80 HP)**



Battery capacity **76 kWh**



Charger **20 kW (32 A)**

## RANGE

SPEED	TIME	DISTANCE
6 km/h (3.2 kts)	12h00	228 km (122 nm)
8 km/h (4.3 kts)	19h00	152 km (82 nm)
10 km/h (5.5 kts)	11h30	115 km (62 nm)
12 km/h (6.5 kts)	5h00	62 km (34 nm)

## CHARGING TIME [20 kW]

Destination charge  
(40 - 80%)

1.5 H

Realistic charge  
(20 - 100%)

3 H

Full charge  
(0 - 100%)

4 H



# DELPHIA 11 SEDAN

## Simplicity at the service of sophistication

The Delphia 11 Sedan offers an easy and peaceful cruising experience with its clean lines and contemporary design. It invites you to live in the moment, thinking only of your well-being on board. Thanks to its intelligent systems and functionality, it is possible to maintain your lifestyle as if you were at home, wherever you are.

The photovoltaic panel system ensures

comfortable and practical electrical autonomy.

The front sun loungers invite you to rest and relax, and can be fitted with an optional sun awning. The Delphia 11 Sedan embodies sustainable innovation for comfortable, environmentally-friendly cruising.

Made in B category, this boat allows you to cruise on all playground in calm weather.



# GENERAL CHARACTERISTICS

## DELPHIA 11 SEDAN

Overall length	10,77 m
Hull length	9,99 m
Hull width	3,85 m
Draft	0,8 m
Light displacement	6 815 kg
Min. engine power	57 hp
Max. engine power	150 hp
Max. engine power in electric version	80 hp (55,10kW)
Fuel tank	400 L
Max. speed (diesel)	17.5 km/h
Max. speed (electric)	16.5 km/h
Fresh water tank	380 L
Black water tank	170 L
Grey water tank	170 L
Air draught	2,95 m / 3,30 m
CE-category	B10, C14, D14
Designer	Tony Castro Yacht Design

## Roof



1. 8 solar panels
2. Sliding roof hatches
3. Folding antennas
4. Folding radar mast
5. Bow sprit with integrated telescopic ladder

## Main deck



1. Outside galley
2. U-shaped cockpit bench seat with storage
3. Storage for life raft
4. Hull side gate
5. Bow lounge area

## 1 cabin & 1 bathroom



1. U-shaped dining bench
2. Lifting TV mechanism
3. Separate shower
4. Office/utility room
5. Owner's cabin with Queen size double bed

## 2 cabins & 1 bathroom



1. Ample storage space under the bed
2. Guest cabin with French size bed
3. Generous separate shower stall
4. Bathroom including electric toilet
5. Owner's cabin with Queen size double berth

## 2 cabins & 2 bathrooms

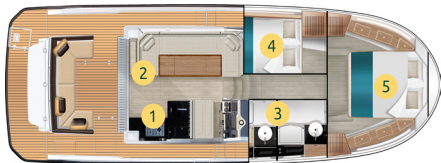

1. Dishwasher
2. Fridge drawer
3. Two identical bathrooms with separate showers
4. Guest cabin with double bed
5. Owner's cabin with Queen size double berth

## 3 cabins & 2 bathrooms

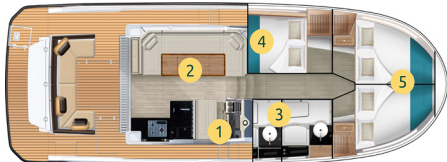

1. Sliding side door at helm
2. Folding & lowerable dining table
3. Two identical bathrooms with separate showers
4. Guest cabin with double bed
5. Two identical cabins forward

/ Delphia 11 SEDAN

« Best in class for space utilisation and ergonomics »

DID  
YOU  
KNOW ?

The speed limit for most canals in France is 8km/h.



Large sunbathing area



Nest effect



Well-thought-out interior  
and exterior features





A scenic landscape featuring a vibrant green field in the foreground, a calm body of water reflecting the sky, and a line of trees and houses in the distance under a dramatic, cloudy sky. A large white curved shape on the left side of the image frames the text.

# DELPHIA 11 FLYLOUNGE

## Cruising together with peace of mind

The Delphia 11 Flylounge is a boat designed for those who dream of getting away from it all for several days with family or friends. Equipped with the latest navigation technology, it will take you to new horizons with complete confidence, whether powered by an electric or internal combustion engine. Its environmentally-friendly construction uses eco-responsible materials, and its cockpit cover offers complete protection from the elements.

With its elegant design, the Delphia 11 FlyLounge

offers unique comfort both inside and out. The salon, bathed in natural light offers a 360 view of the surroundings. The spacious living areas welcome the whole family, while respecting everyone's privacy. The fully equipped kitchen lets you prepare delicious meals just like at home. The 2 cabins, with their ergonomic beds and ingenious stowage space, make travelling together a peaceful and comfortable experience.

Made in B category, this boat allows you to cruise on all playground in calm weather.



## GENERAL CHARACTERISTICS

### DELPHIA 11 FLYLOUNGE

Overall length	10,77 m
Hull length	9,99 m
Hull width	3,85 m
Draft	0,8 m
Light displacement	7 314 kg
Min. engine power	57 hp
Max. engine power	150 hp
Max. engine power in electric version	80 hp (55,10kW)
Fuel tank	400 L
Max. speed (diesel)	17.5 km/h
Max. speed (electric)	16.5 km/h
Fresh water tank	380 L
Black water tank	170 L
Grey water tank	170 L
Air draught	2,95 m / 3,30 m
CE-category	B10, C14, D14
Designer	Tony Castro Yacht Design

## Flybridge



1. 2 solar panels
2. Folding backrest
3. Lifting helm station
4. Drawer fridge / BBQ storage
5. Sunbed

## Main deck



1. Cockpit table
2. Folding stairs to Flybridge
3. Fender locker
4. Fold-down table creating a double bed
5. Bow lounge area with storage tablets

## 1 cabin & 1 bathroom



1. Extraction hood
2. Bottle storage
3. Washer/dryer
4. Bathroom
5. Owner's cabin with Queen size double bed

## 2 cabins & 1 bathroom



1. Ample storage space under the bed
2. Guest cabin with french size bed
3. Generous separate shower stall
4. Bathroom including electric toilet
5. Owner's cabin with Queen size double berth

## 2 cabins & 2 bathrooms



1. 3-burners gas cooker
2. U-shaped dining area
3. Two identical bathrooms with separate showers
4. Guest cabin with double bed
5. Owner's cabin with Queen size double bed

## 3 cabins & 2 bathrooms



1. Sliding side door at helm
2. Storage under the bench
3. Microwave oven
4. Two identical cabins in bow
5. Removable middle bulkhead

/ Delphia 11 FLYLOUNGE

« **Impressive size** of the flybridge - seen only on larger yachts »

**DID  
YOU  
KNOW** ?

Your fuel consumption at cruising speed (8km/h) with 150hp diesel engine is just 1,2 liter per hour.



Incredible  
interior space



Ergonomic



Complete cockpit  
enclosure system





# ELECTRIC CONCEPT

Performances: DELPHIA 11 models



**Delphia has developed 3 different electric systems to fit different use cases and available infrastructure**

\*All data are based on sea trials in MLC condition, flat seas, no wind, sea and outside temperature below 10° celsius and may vary due to water density and type of propeller



“Life” represents a first step in Delphia’s conscious boating for boaters who use their boats in limited boating areas, such as lakes, urban areas or who tend to enjoy short cruises or day trips.

## LIFE



Electric motor **55,10 kW (80 HP)**



Battery capacity **38 kWh**



Charger **3.2 kW (1 x 16 A)**

## RANGE

### SPEED

6 km/h (3.2 kts)

### TIME

14h00

### DISTANCE

85 km (46 nm)

8 km/h (4.3 kts)

7h00

56 km (28 nm)

10 km/h (5.5 kts)

3h30

35 km (19 nm)

12 km/h (6.5 kts)

1h45

24 km (13 nm)

## CHARGING TIME [3.2 kW]

Destination charge  
(40 - 80%)

5 H

Realistic charge  
(20 - 100%)

10.5 H

Full charge  
(0 - 100%)

12 H



Electric motor **55 kW (80 HP)**



Battery capacity **76 kWh**



Charger **3 x 3.2 kW (1 x 16 A / 3 x 16 A)**

## RANGE

SPEED	TIME	DISTANCE
6 km/h (3.2 kts)	28h00	168 km (91 nm)
8 km/h (4.3 kts)	14h00	112 km (60 nm)
10 km/h (5.5 kts)	7h00	70 km (38 nm)
12 km/h (6.5 kts)	3h30	42 km (23 nm)

## CHARGING TIME

Destination charge  
(40 - 80%)



Realistic charge  
(20 - 100%)



Full charge  
(0 - 100%)



[3.2 kW]  
[9.6 kW]

# CRUISE

The «Cruise» system is designed for explorers who like to take their loved ones to isolated bays or remote villages, and who are looking for greater autonomy and additional features.





“Rapid” system, looks to the future – meaning, those owners who navigate in areas where infrastructure is already in place for fast charging.

## RAPID



Electric motor **55 kW (80 HP)**



Battery capacity **76 kWh**



Charger **20 kW (32 A)**

## RANGE

SPEED	TIME	DISTANCE
6 km/h (3.2 kts)	28h00	168 km (91 nm)
8 km/h (4.3 kts)	14h00	112 km (60 nm)
10 km/h (5.5 kts)	7h00	70 km (38 nm)
12 km/h (6.5 kts)	3h30	42 km (23 nm)

## CHARGING TIME [20 kW]

Destination charge  
(40 - 80%)

1.5 H

Realistic charge  
(20 - 100%)

3 H

Full charge  
(0 - 100%)

4 H



# DELPHIA 12 SEDAN

## Delphia's flagship

Delphia 12 Sedan is the flagship of the Delphia range, combining harmony and performance with ultimate comfort. Its contemporary design combines aesthetics and functionality in every detail carefully thought out for you.

The Delphia 12 Sedan's functional kitchen makes easy to create gourmet meals, and her large windows offer uninterrupted views of the outside environments. The peaceful and soothing interior ambience, created by the use of top-quality

materials and impeccable finishes, makes this boat a real haven of peace. The two well-appointed cabins guarantee a restful rest and the powerful diesel engine combines fuel efficiency with performance.

Made both for inland and sea cruises, the category B allows you to travel along and off the coast in calm weather. The Delphia 12 Sedan is the perfect companion to explore your desire thanks to its stability and large spaces.



# GENERAL CHARACTERISTICS

## DELPHIA 12 SEDAN

Overall length	13,40 m
Hull length	12 m
Hull width	4,26 m
Draft	0,84 m
Light displacement	8 500 kg
Min. engine power	110 hp
Max. engine power	230 hp
Fuel tank	300 L + 300 L
Max. speed (diesel)	19.5 km/h
Fresh water tank	200 L + 300 L
Black water tank	250 L
Grey water tank	150 L
Air draught	2.65 m
CE-category	B8, C12
Designer	Andrzej Skrzat Tony Castro Yacht Design

## Exterior

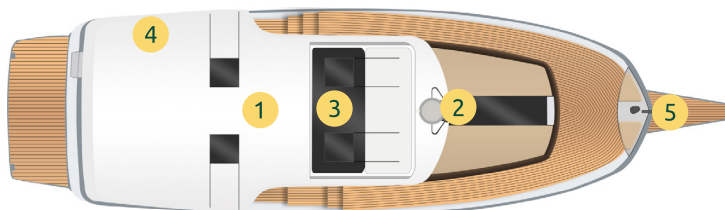

1. 2 opening small hatches
2. Folding radar mast
3. Electric sliding roof hatch
4. Folding antennas
5. Bow sprit

## Interior

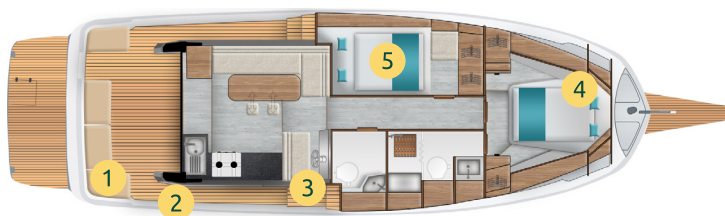

1. L-shaped cockpit bench seat
2. Side exit doors
3. Sliding side door at helm
4. Owner's cabin with private bathroom
5. Guest cabin with double bed

/ Delphia 12 SEDAN

« Life on one level for carefree movement on board »

DID  
YOU  
KNOW ?

There are more than 27 million lakes in the world on which you can navigate!



Extra wide side deck



Fully equipped kitchen



Additional access  
to the boat



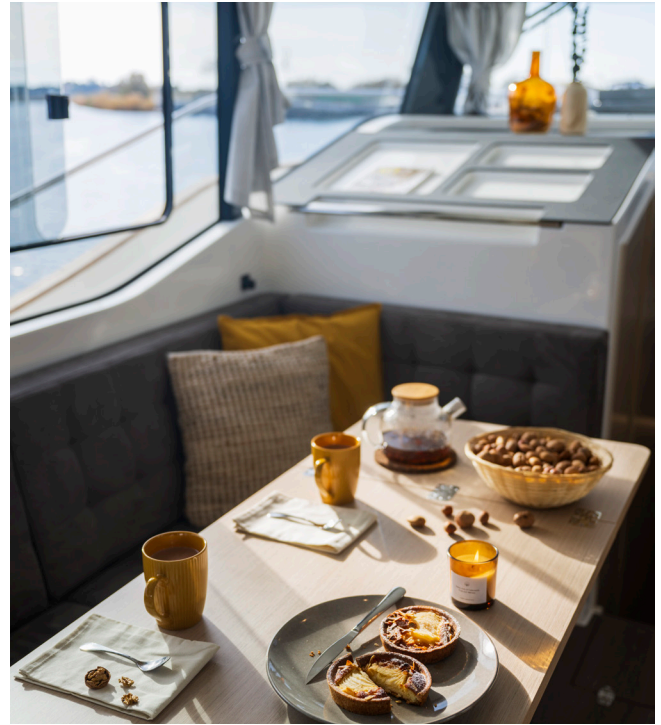



# DELPHIA 12 FLYLounge

## Travelling in complete privacy

The Delphia 12 FlyLounge is the ideal boat for intimate cruises that encourage relaxation and reconnection.

This boat is for lovers of comfortable travel. A real house on the water, its set up ensures privacy. Designed for pleasant stays, the interior of the cockpit is bathed in light and offers a 360° view, while the exterior allows you to move freely from the sun deck to the bar.

The fully-equipped galley encourages sharing, from preparation to tasting. The two cabins have plenty of storage space, so you can bring along the wardrobe you need for every occasion.

Equipped with one or two engines, the FlyLounge offers the very best in low-speed cruising and maximize on-board comfort. Designed in B category, it can go at sea and along the coast.



# GENERAL CHARACTERISTICS

DELPHIA 12 FLYLOUNGE	
Overall length	13,40 m
Hull length	12 m
Hull width	4,26 m
Draft	0,84 m
Light displacement	8 750 kg
Min. engine power	110 hp
Max. engine power	230 hp
Fuel tank	300 L + 300 L
Max. speed (diesel)	19.5 km/h
Fresh water tank	200 L + 300 L
Black water tank	250 L
Grey water tank	150 L
Air draught	3.63 m
CE-category	B8, C12
Designer	Andrzej Skrzat / Tony Castro Yacht Design

## Exterior

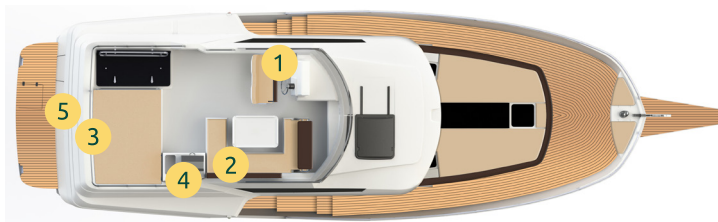

1. Helm station
2. Dining area
3. Aft sundeck
4. Outside galley
5. Folding antennas

## Interior



1. L-shaped cockpit bench seat
2. Spacious salon with pouff seats
3. Fully equipped kitchen
4. Washer / dryer
5. Separate shower

/ Delphia 12 FLYLOUNGE

« Her size and attention to details are impressive and sets new standards in her class »

DID  
YOU  
KNOW ?

The engines installed in the Delphia 12 are among the cleanest diesel engines in the market, with possibility of running on HVO biofuels and emissions low enough to be authorised for cruising on Lake Constance.



360° vision from the helm

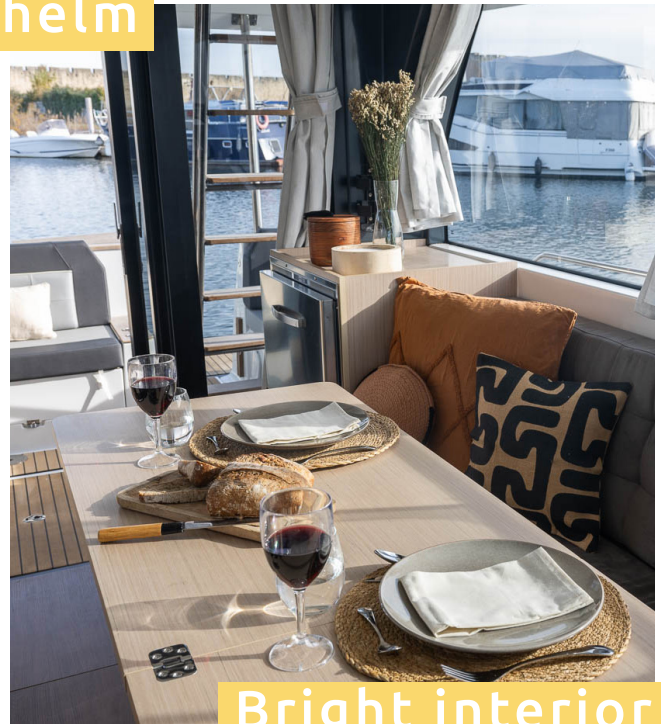

Bright interior



Single or twin motor configuration





# OUR MINDSET



“ Being environmentally aware is not just about the environment, it’s also about people’s well-being. It’s a way of thinking and acting, and a principle that must guide us.

## ENGINES

Our electric propulsion system has a very positive carbon footprint, as it creates no pollution of any kind, is silent and produces no heat or fuel smells. We have carefully chosen our partner for our thermic propulsion system: Yanmar, whose diesel engines comply with the latest emissions regulations and standards.

## ELECTRICITY

Thanks to the clean, emission-free energy produced by the solar panels, we offer a renewable source of electricity on board. We chose LED lights for our boats because they consume almost 5 times less energy than ordinary lights.

## MATERIALS

For our boats, we have chosen a synthetic deck material rather than traditional tropical hardwoods. This particular material is an excellent alternative for minimising our environmental footprint and is easy to recycle. Our balsa wood is biodegradable and comes from sustainable plantations, responsibly managed with environmentally friendly harvesting and processing. The wood used for the on-board furniture comes from certified forests that respect biodiversity as much as possible. This allows us to fully control the supply chain and ensure product traceability.

## FABRICS

We have chosen to use as many recycled fibres, yarns and fabrics as possible to reduce waste.

## WASTE MANAGEMENT

On board, you will find large tanks for water and waste, so you can dispose of your rubbish when you are docked.

## TO FIND OUT MORE

We encourage e-mobility by installing a charging point for electric bikes on our boats.

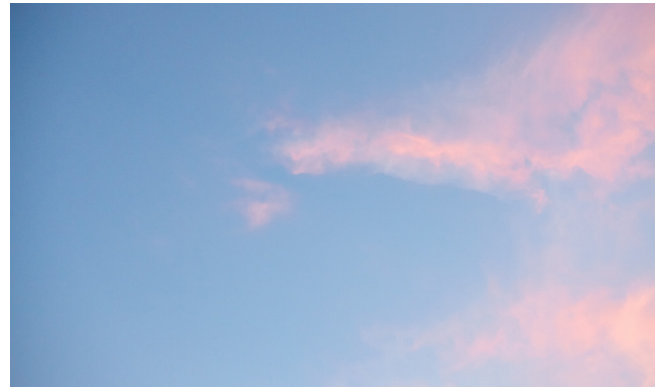

# OUR PARTNERS

DID  
YOU  
KNOW ?

At cruising speed, our Delphia are quieter than a dishwasher.

## GARMIN®

**A NEW CHAPTER IS ABOUT TO BEGIN IN DELPHIA HISTORY, AND TRUSTED PARTNER GARMIN IS PROUD TO BE PART OF THE ADVENTURE.**

You love getting out on the water. Not a day goes by without thinking of it. The smells, the sounds, the feeling of being elsewhere. We design Garmin Marine products that are easy to understand, simple to use, intuitive, and dependable from season to season. This way, your Garmin Marine electronics will be reliable during each new outing. Even when you're not on the water, you can stay connected to your boat with the ActiveCaptain™ app.

[www.garmin.com](http://www.garmin.com)





## WE CREATE THE FUTURE OF HOW PEOPLE MOVE ON THE WATER

As pioneers in the field of on-water electromobility, Torqeedo has set many standards since its inception, reinforcing the lead of its motors over all other propulsion solutions available on the market. Torqeedo offers outboard and inboard motors, electric motors and hybrid drive systems from 0.5 to 100 kW at motor level (up to 200 kW at system level).



The Seanapps mobile application and its on-board unit offer a host of features for an optimal navigation experience.

You can use your smartphone to consult information such as battery charge status, water tank levels and upcoming maintenance operations.

Seanapps allows you to plan your departure with complete peace of mind, ensuring that your boat is always ready to sail. What's more, an integrated alert system notifies you in real time of any po-



## YANMAR HAS LONG HAD A CLOSE RELATIONSHIP WITH THE SEA.

For more than a century, Yanmar has shared the beauty of the sea with its customers. As a leading supplier of marine engines for industry and leisure, Yanmar is committed to providing the highest quality equipment that delivers superior performance and value over its lifetime, with minimal impact on the environment.



tential problems (disconnection of the dock connector, for example). So you'll always know what's going on with your boat.

The application facilitates interaction with your dealer, allowing you to plan and manage servicing and repairs with ease to solutions that are adapted, practical and comfortable...

seanapps

CONNECT YOUR BOAT FREE YOUR MIND



**DELPHIA**

*Mindful Cruising*